



Z1726

ADJUSTABLE FLOOR DRAIN MEDIUM DUTY

SPECIFICATION SHEET

TAG _____

Dimensional Data (inches and [mm]) are Subject to Manufacturing Tolerances and Change Without Notice

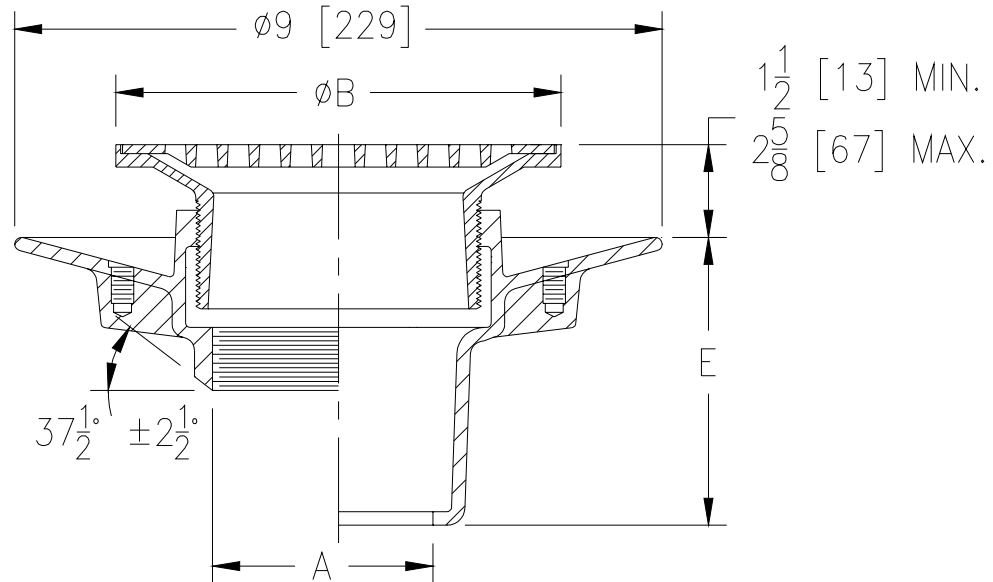

Dimensions In Inches		Approx. Wt. Lbs. [kg]	Strainer Open Area Sq. In. [cm ²]
A Pipe Size	B Strainer Dia.		
2-3 [51-76]	5 [127]	13 [6]	7 [45]
2-3-4 [51-76-102]	6 [152]	13 [6]	11 [71]
2-3-4 [51-76-102]	7 [178]	14 [6]	15 [97]
3-4-6 [76-102-152]	8 [203]	16 [7]	20 [129]
6 [152]	10 [254]	19 [9]	27 [174]

ENGINEERING SPECIFICATION: ZURN Z1726 All Type 304 (CF8) stainless steel adjustable floor drain with anchor flange (clamp collar with seepage holes, when specified), and 6 [152] diameter medium-duty vertically adjustable, satin finish top.

OPTIONS (Check/specify appropriate options)

PIPE SIZE

2 thru 4, 6 [51 thru 102, 152]

2 thru 4 [51 thru 102]

2 thru 4 [51 thru 102]

(Specify size/type) **OUTLET**

- _____ BW Butt-weld
(Specify Schedule 10, 40 or 80)
- _____ IC Inside Caulk
- _____ IP Threaded

'E' BODY HT. DIM.

- 2 7/8 [73]
- 4 3/8 [111]
- 2 7/8 [73]

PREFIXES

- _____ Z Type 304 (CF8) Stainless Steel Body*
- _____ ZC Type A-27 Carbon Steel Body (P.O.A.)
- _____ ZM Type 316 (CF8M) Stainless Steel Body
- _____ ZL Type 316L (CF3M) Stainless Steel Body

SUFFIXES

- _____ -K Seepage Holes Only
- _____ -KC Clamp Collar with Seepage Holes
- _____ -RD5 5 [127] Diameter Type 304 Stainless Steel Top
- _____ -RD7 7 [178] Diameter Type 304 Stainless Steel Top
- _____ -RD8 8 [203] Diameter Type 304 Stainless Steel Top
- _____ -RD10 10 [254] Diameter Type 304 Stainless Steel Top
- _____ -SG Solid Gasketed Cover
- _____ -V Bronze Backwater Valve
- _____ -VP Vandal-Proof Secured Top
- _____ -Y Stainless Steel Sediment Bucket
- _____ -90 90° Side Outlet

REV. H	DATE: 10/12/04	C.N. NO. 92658
DWG. NO. 59294	PRODUCT NO. Z1726	

*REGULARLY FURNISHED UNLESS OTHERWISE SPECIFIED