

Model BVEC

Full Port Brass Ball Valve with
Thermal Expansion Control
(3/4" & 1")

WILKINS
a ZURN company

□ Installation □ Maintenance Instructions

INSTALLATION INSTRUCTIONS

1. Before installation of valve, flush line thoroughly to remove all foreign matter from the line.
2. The Wilkins' Model BVEC should be installed on the cold water inlet of the water heater. Install so that the thermal relief valve is on the downstream side of the ball valve shut off.
3. **CAUTION: TO AVOID WATER DAMAGE DUE TO RELIEF VALVE OPERATION, A DISCHARGE LINE MUST BE CONNECTED TO THE RELIEF VALVE OUTLET AND DIRECTED TO A SAFE DISPOSAL.**
4. THE DISCHARGE LINE SHALL BE VERTICAL OR DOWNWARD SLOPING AND TERMINATE AT LEAST 3 INCHES ABOVE THE DRAIN.
5. THREADS ARE PROHIBITED AT THE DISCHARGE END OF THE RELIEF LINE.
6. The drainage line of the relief valve must be piped independently of the water heater relief valve drain.
7. The discharge line shall be secured to prevent movement of the line during discharge.

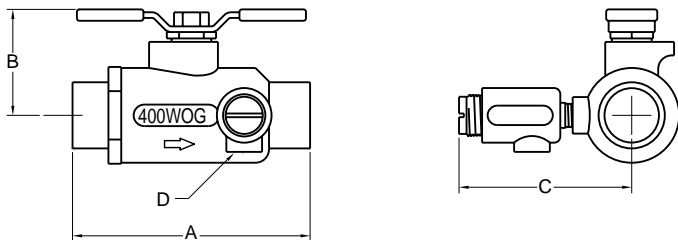

MAINTENANCE

The thermal expansion relief valve is designed to relieve pressure periodically as the water heats. An average 40 gallon water heater will discharge approximately 1/3 of a gallon during a reheat cycle. If the relief valve should fail and discharge continuously, discard and replace with a new control valve.

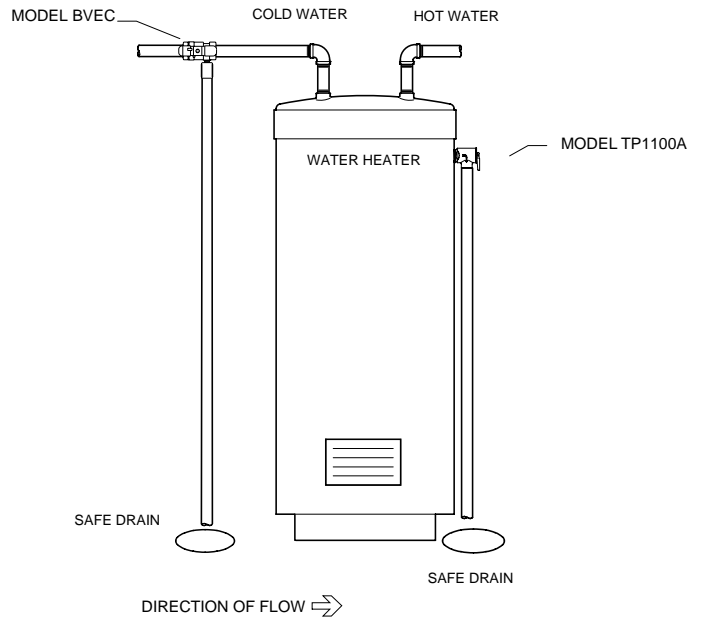

TYPICAL INSTALLATION

MODEL	SIZE		CONNECTION	DIMENSIONS (approximate)								WEIGHT	
	in.	mm		A		B		C		D	lbs.	kg	
				in.	mm	in.	mm	in.	mm				
34-BVECC	3/4	20	SWEAT	3 15/16	100	1 15/16	49	2 13/16	71	1/8" FNPT	1 3/8	0.6	
34-BVEC	3/4	20	FNPT	2 3/4	70	1 5/8	41	2 13/16	71	1/8" FNPT	1	0.5	
1-BVEC	1	25	FNPT	3 1/4	83	1 15/16	49	2 15/16	75	1/8" FNPT	1 1/2	0.7	

WARRANTY: WILKINS Valves are guaranteed against defects of material or workmanship when used for the services recommended. If in any recommended service, a defect develops due to material or workmanship, and the device is returned, freight prepaid, to WILKINS within 12 months from date of purchase, it will be repaired or replaced free of charge. WILKINS' liability shall be limited to our agreement to repair or replace the valve only.

Proposition 65 Warning This product contains chemicals known to the State of California to cause cancer or birth defects or other reproductive harm.

WILKINS
a ZURN company