

**ARCHITECTURAL & ENGINEERING SPECIFICATION**

Prefabricated stainless steel shower unit consisting of the TEMP-GARD pressure balancing shower valve with single bronze stem, stainless steel balancing piston & bottom access integral service stops. Standard with 1/2" [13mm] copper tubing assembly enclosed by 18 gage stainless steel #4 brushed finish shroud, chrome plated brass shower head with flow control on institutional bracket, metal stem handle, side mount soap dish & all vandal proof securing screws.

**PRODUCT FEATURES**

- Pressure balancing shower valve with single bronze stem
- Chrome plated brass shower head with flow control
- 18 Gage Stainless Steel shroud

**COMPLIANCE AND CERTIFICATION:**

- Shower head, valve and plumbing fittings- Complies with ASME A112.18.1 / CSA B125.1
- ADA Compliant
- Valve - Complies with ASSE 1016-2005

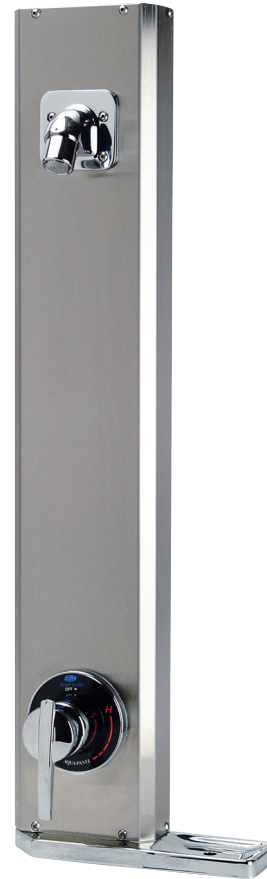
**SUFFIX OPTIONS**

-1.25	1.25 GPM Shower Head Flow Control
-1.5	1.5 GPM Shower Head Flow Control
-1.75	1.75 GPM Shower Head Flow Control
-2.0	2.0 GPM Shower Head Flow Control
-LS	Less Soap Dish
-SL	Short Length Shroud 26" (660mm)
-TC	Matching Shroud Extension to Cover Thru Ceiling Piping (Specify extension height)
-TH	Matching Shroud Cover For Concealed Horizontal Piping (Application drawings available for custom installations)

ARCHITECTURAL &amp; ENGINEERING APPROVAL

The information contained in this document is subject to change without notice.  
Please contact Zurn for most up to date information.

# Rough-in/Overview dimensions

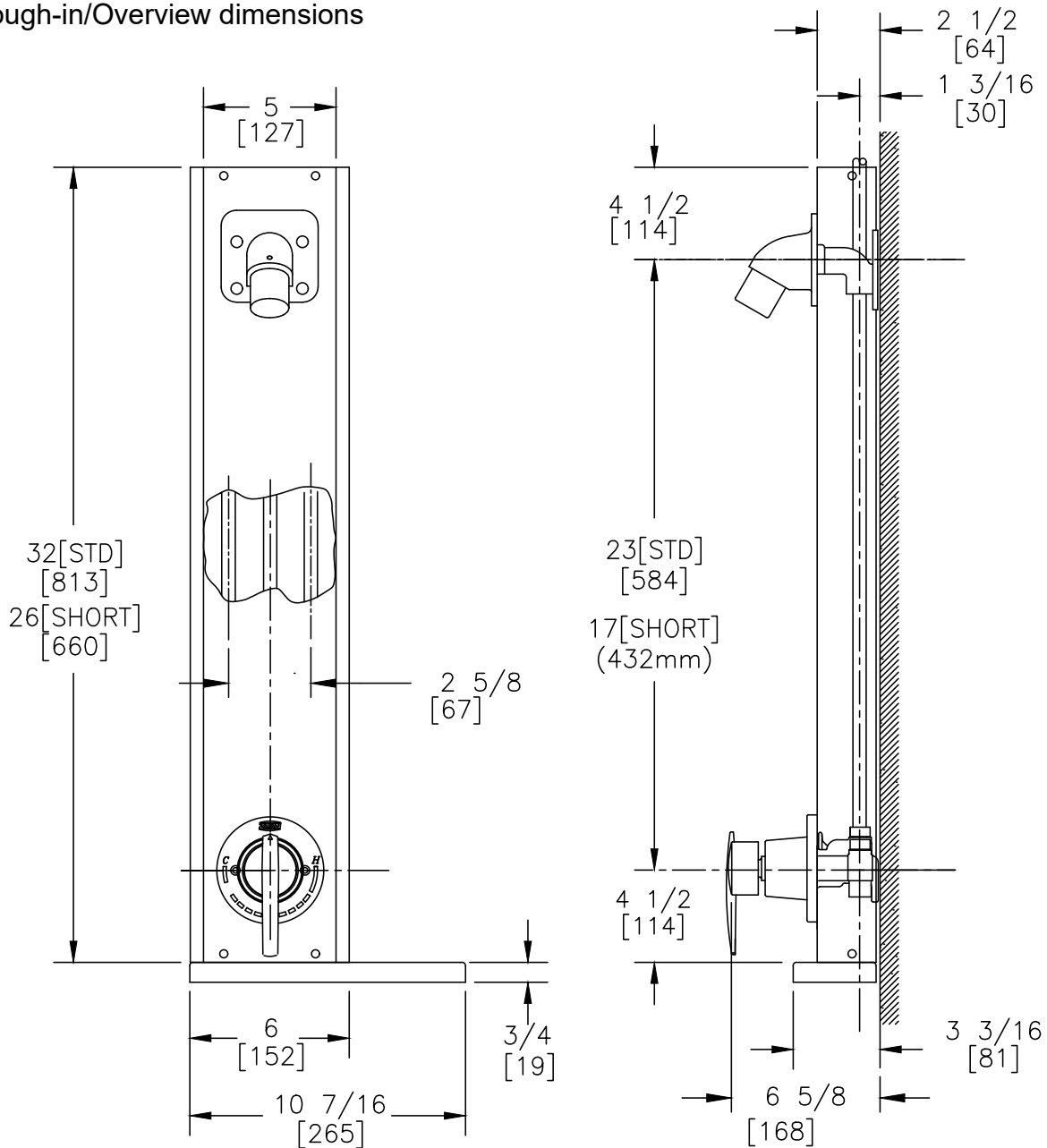

NOTE: All dimensions are for reference only. Do not use for pre-plumbing.