

**Z1471 PIPE CLAMP HARDWARE Assembly Instructions**

Dimensional Data (inches and [mm]) are subject to manufacturing tolerances and change without notice.

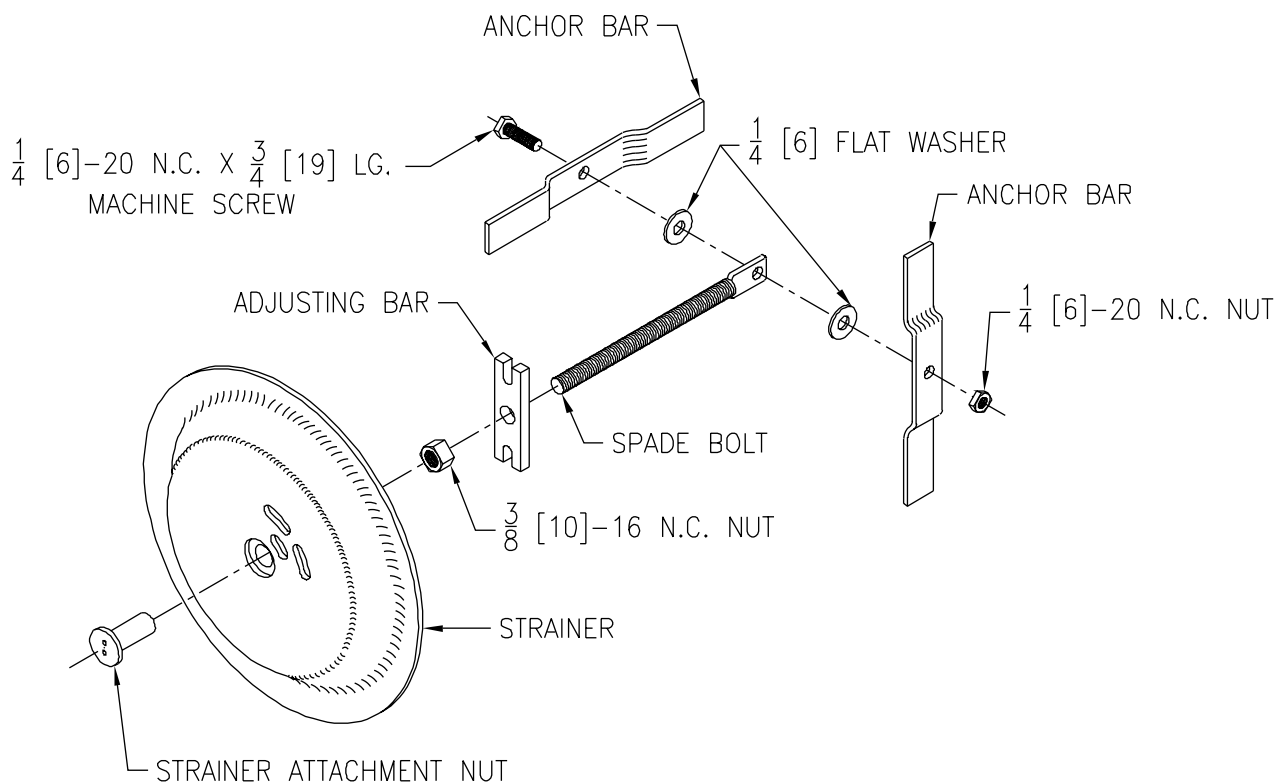

**Z1471 PIPE CLAMP HARDWARE**

1. Assemble the two anchor bars (with formed offsets toward spade bolt) to spade bolt using:

- (1) 1/4" [6]-20 NC x 3/4" [19] Long Machine Screw
- (1) 1/4" [6]-20 NC Nut
- (2) 1/4" [6] Flat Washers

Place a 1/4" [6] flat washer on each side of spade bolt, then place an anchor bar on each side of the 1/4" [6] flat washer (a 1/4" [6] flat washer goes between the spade bolt and anchor bar on each side). Place the 1/4" [6]-20 NC x 3/4" [19] long machine screw through the entire assembly and thread on the 1/4" [6]-20 NC nut.

Note that the 1/4" [6]-20 NC machine screw and nut holding the anchor bars (in an "X" configuration) to the spade bolt **should not be tightened**. The nut should be run onto the machine screw until 4 or 5 threads of the machine screw are past the nut.

- 2. Slide the adjusting bar onto the threaded end of the spade bolt.
- 3. Thread the 3/8" [9]-16 NC nut onto the threaded end of the spade bolt in front of the adjusting bar.
- 4. **DO NOT** attach the strainer and strainer attachment nut. These will be used at final installation (see Page 10).

The assembly is ready to be installed in pipe.