

# AQUASPEC FAUCETS

MODELS - G61754, G62682, G67800, G67874,  
G68018

METERING CARTRIDGES



## TECHNICAL INFORMATION

**MAXIMUM PRESSURE:** 125 PSI

**MAXIMUM TEMPERATURE:** 180°F

**IMPORTANT** THE WATER SUPPLY LINES MUST BE THOROUGHLY FLUSHED BEFORE INSTALLATION TO PREVENT FOREIGN MATTER AND DEBRIS FROM CLOGGING AND/OR DAMAGING INTERNAL COMPONENTS AND THEREBY PREVENTING THE FAUCET FROM FUNCTIONING PROPERLY

**IMPORTANT** THE FILTER ASSEMBLY INCLUDED WITH THIS FAUCET MUST BE INSTALLED AS INSTRUCTED TO FURTHER PREVENT FOREIGN MATTER AND DEBRIS FROM DAMAGING THE FAUCET AND TO ENSURE PROPER FUNCTIONING.

**⚠ WARNING:** Cancer and Reproductive Harm - [www.P65Warnings.ca.gov](http://www.P65Warnings.ca.gov)

**⚠ ADVERTENCIA:** Cáncer y daño reproductivo - [www.P65Warnings.ca.gov](http://www.P65Warnings.ca.gov)

**⚠ AVERTISSEMENT:** Cancer et effets néfastes sur la reproduction - [www.P65Warnings.ca.gov](http://www.P65Warnings.ca.gov)

## INSTALLATION INSTRUCTIONS

1. REMOVE HANDLE NUT ASSEMBLY(#1) USING 1 1/8" HEX 6 POINT SOCKET.
2. DISCARD CAP SEALING WASHER ASSEMBLY(#2)
3. ENSURE O-RING(#3A) AND WASHER(#3B) ARE POSITIONED ON BLUE POLYMER SLEEVE AS SHOWN.
4. INSERT METERING CARTRIDGE(#3) INTO FAUCET BODY.
5. RE-INSTALL HANDLE NUT ASSEMBLY(#1) USING 1 1/8" HEX 6 POINT SOCKET. TIGHTEN UNTIL SEAL IS ACHIEVED UNDER HANDLE NUT . IT MAY BE NECESSARY TO REMOVE WASHER(#3B) FROM METERING CARTRIDGE TO ACHIEVE SEAL.
6. CYCLE TIME ADJUSTMENT  
TURN ADJ. NUT UP (CCW) FOR SHORTER CYCLE  
TURN ADJ. NUT DOWN (CW) FOR LONGER CYCLE

NOTE: G62682 FUNCTIONS AS ON/OFF VALVE AND IS **NOT** SLOW CLOSING

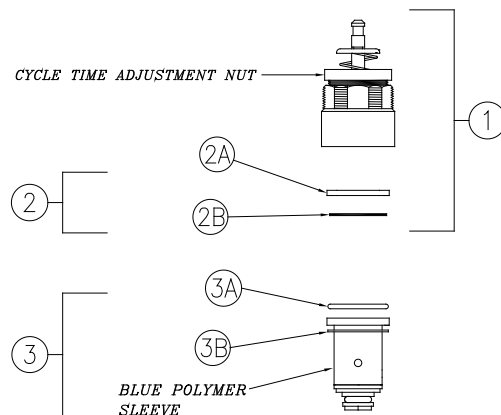

G60561, G65503, G61754  
PICTURED

### PARTS LIST

Item	Part Number	Description	Qty.	Item	Part Number	Description	Qty.
1	G60561	HANDLE NUT ASSEMBLY	1	3	G61754	METERING CARTRIDGE	1
2	G65503	CAP SEALING WASHER ASS.	1	3A	58155020	O-RING	1
2A	65431002	PLASTIC WASHER	1	3B	81241001	WASHER	1
2B	65432001	PLASTIC WASHER	1				

PAGE 1 OF 1