

Model BMSK LEAD-FREE*

Integral Relief Valve Monitor Switch Kit
(3/4", 1", 1 1/4" 1 1/2" & 2")

*This product contains a weighted average lead content less than 0.25% for wetted surfaces



☐ Installation ☐ Operation ☐ Maintenance Instructions

SPECIFICATIONS

Alarm housing material:	ABS plastic
Dry cell battery:	9v DC
Fasteners:	Stainless steel
Relief valve switch rating:	3A @ 9VDC
Alarm decibel rating:	100
Low battery indication:	Non-Blinking LED or low "chirp" alarm sound
Remote switch closure rating:	Oscillating 1A @125VAC or 1A @24VDC closure.
Remote switch closure interface:	RJ11 (4 wire) telephone jack

APPLICATION

The battery operated monitor switch electrically supervises the relief valve in the closed position. In the event of a backpressure or backsiphonage condition, the relief valve contacts a switch in the cover which completes the alarm circuit, activates an intermittent alarm and an LED, and triggers a switch closure for a remote light, buzzer or other alarm system. The BMS is also equipped with a 10 second delay, allowing the valve to reset itself after an intermittent line pressure fluctuation without sounding the alarm. This monitor switch system is intended for **indoor** installation.

INSTALLATION INSTRUCTIONS

- For new indoor 975XL2BMS or upgraded 975XL2 assemblies, place valve in service per the installation instructions.
- If a remote alarm or other alarm system is to be used with the BMS, connect it to the BMS's RJ11 plug.
- Toggle the BMS on/off switch to the "on" position.
- The LED flashes every 40 seconds, indicating battery life, and flashes with the buzzer during valve discharge.
- If the valve is discharging and a loud, rapid alarm is sounding, close inlet and outlet shut-off valves.
- Toggle the BMS switch to the "off" position and refer to the maintenance instructions for valve servicing.
- If the valve is not discharging and a quiet, chirping alarm is heard, replace the battery (See Battery Replacement).
- For exterior installations, contact the factory for details.

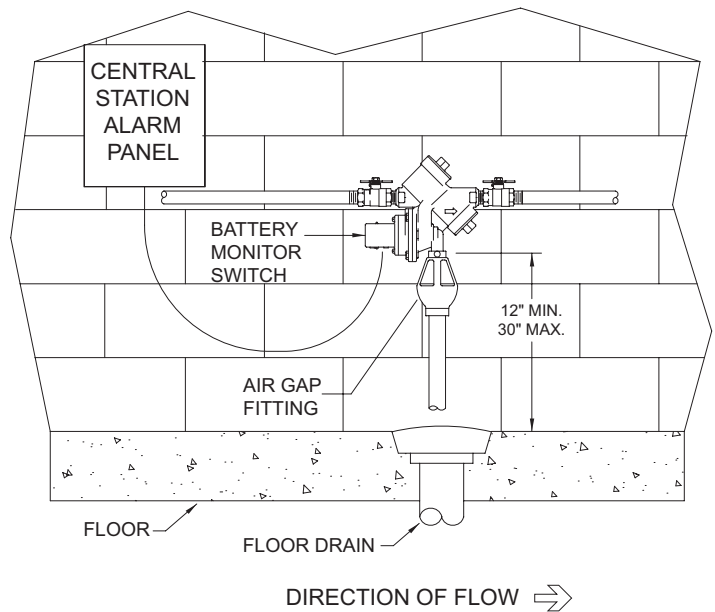

CENTRAL STATION ALARM SYSTEM (INDOOR)

FLOW CHARACTERISTICS

MODEL 975XLMS/975XLBMS 3/4", 1", 1 1/4", 1 1/2" & 2" (STANDARD & METRIC)

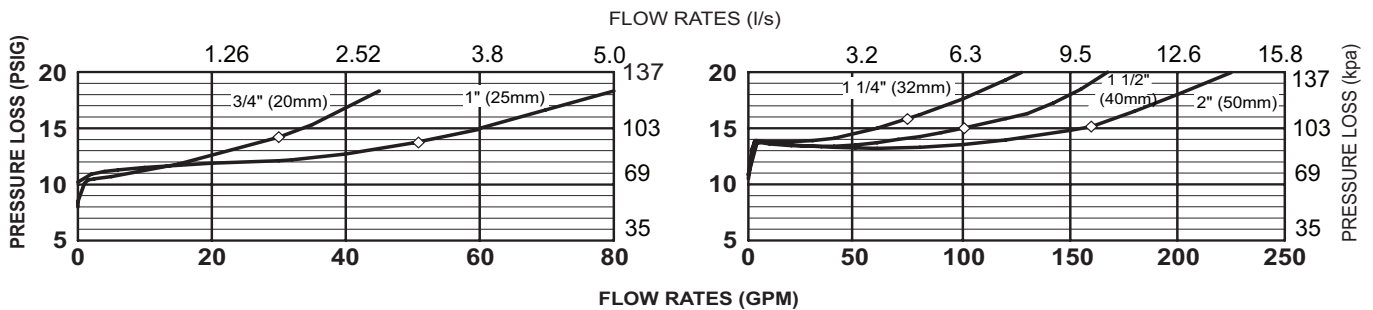

⚠ **WARNING:** Cancer and Reproductive Harm - www.P65Warnings.ca.gov
 ⚠ **ADVERTENCIA:** Cáncer y daño reproductivo - www.P65Warnings.ca.gov
 ⚠ **AVERTISSEMENT:** Cancer et néfastes sur la reproduction - www.P65Warnings.ca.gov



Maintenance

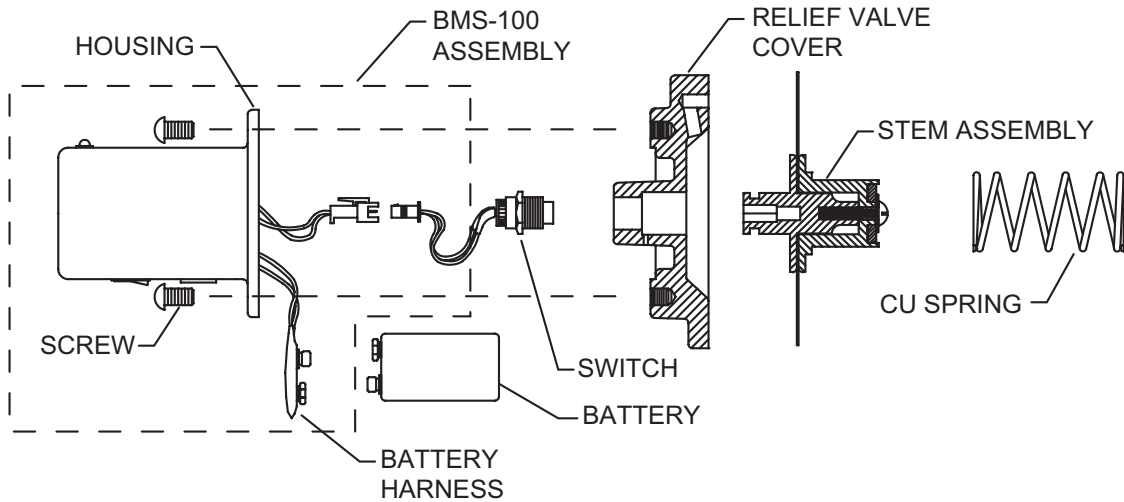

BMS UPGRADES

For field conversion of a 3/4"-2" Model 975XL2 to a Model 975XL2BMS, request the following BMS kits:

SIZE	KIT PART NUMBER	CONTENTS
3/4"-1"	BMSK-34	CU cover, BMS, battery, stem assy and spring
1-1/4"-2"	BMSK-114	CU cover, BMS, battery, stem assy and spring

BATTERY REPLACEMENT

1. Close inlet and outlet shut-off valves and toggle the BMS to the "off" position.
2. Remove the 2 screws that hold the BMS housing to the relief valve cover.
3. Carefully pull the housing away from the relief valve cover.
4. Look into the housing to locate battery. Pull battery out of housing and remove battery harness from battery.
5. Attach new battery to harness. Carefully push battery back into housing and replace housing so that holes align and it is flush with relief valve cover.
6. Place valve and BMS back into service.

Installations

SECURITY AUTO-DIALER ALARM SYSTEM (INDOOR)

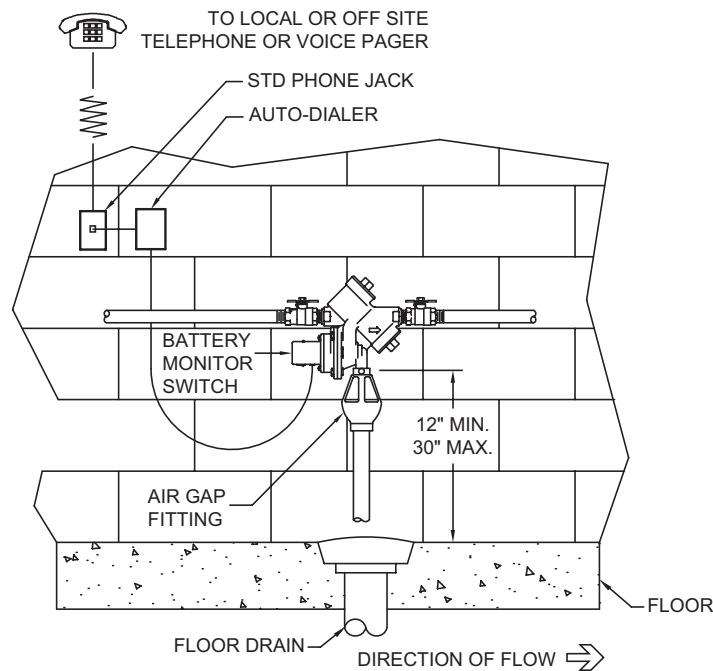

Proper performance is dependent upon licensed, qualified personnel performing regular, periodic testing according to ZURN WILKINS' specifications and prevailing governmental & industry standards and codes and upon following these installation instructions. Failure to do so releases ZURN WILKINS of any liability that it might otherwise have with respect to that device. Such failure could also result in an improperly functioning device.