

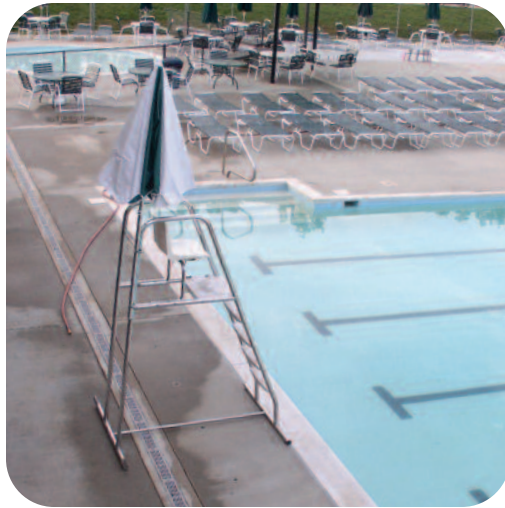

Spec·Sport™

Specified Sport Systems



Swimming Pools

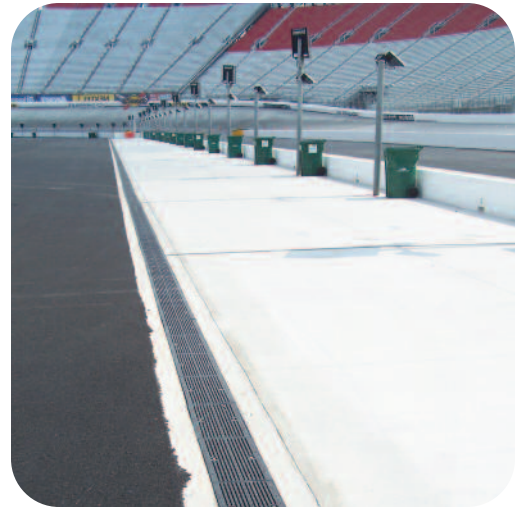

Sports Stadiums



Running Tracks



Sports Rinks

Drainage with Action

Spec·Sport™ Drainage Products

Trench Drains and Catch Basins

Z886 80" Length
Pre-Sloped, HDPE

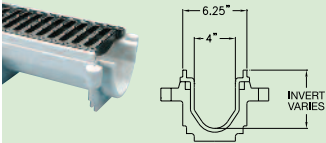

Z883 40" Length
Non-Sloped, Polypropylene

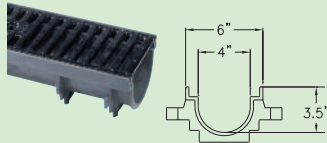

Z884 40" Length, Non-Sloped

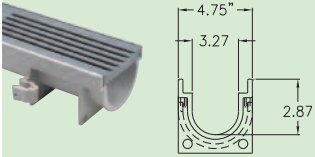

Z882 8' Length, Pre-Sloped, HDPE

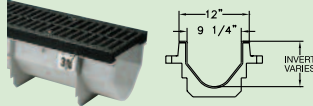

Z880 4' Length, Non-Sloped, Plastic
Additional colors available upon request.

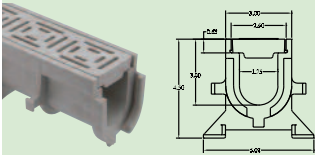

Z887 6" x 20" Catch Basin
Available in 12" x 24" and 24" x 24".

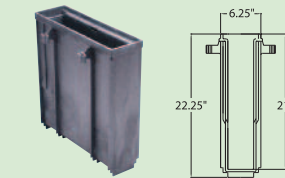

Slot Drains

Z888-4 40" Length, Non-Sloped
Available with 4" extension and heavy-duty frame.

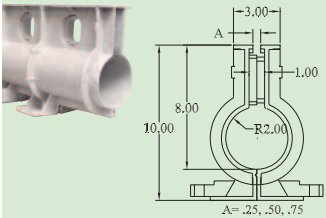

Z888-6 40" Length, Non-Sloped
Available with 4" extension and heavy-duty frame.

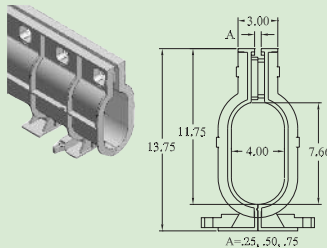

Utility Trench – Special Duty

Z874-U-HD

Available in medium-duty systems with aluminum frames and covers, or steel covers.

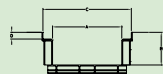
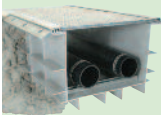

Grate	Dimensions in Inches			
	A Throat Width	B Max. Depth	C Grate Width	D Grate Height
Z874-U-4-HD	4 [102]	22 [559]	6 [152]	3/4 [19]
Z874-U-9-HD	9 [229]	22 [559]	12 [305]	1-1/4 [32]
Z874-U-12-HD	12 [305]	30 [762]	17 [432]	1-3/4 [44]
Z874-U-18-HD	18 [457]	30 [762]	23 [584]	1-3/4 [44]
Z874-U-19-HD	19 [483]	30 [762]	24 [610]	1-3/4 [44]
Z874-U-21-HD	21 [533]	30 [762]	27 [686]	1-3/4 [44]

The Z874-U is a neutral, non-sloped utility drain system. Depths of this system may range from 4" to 30".

Heelproof plastic grates available in custom colors.
ADA/heelproof compliant available.

Standard Non-Sloped Track Layout with Removable Grate

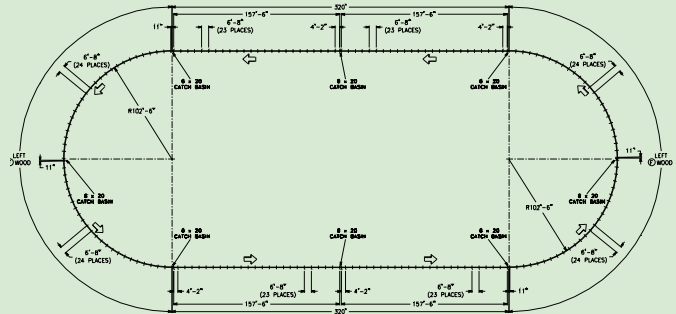

Standard Sloped Track Layout with Removable Grate

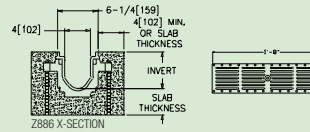
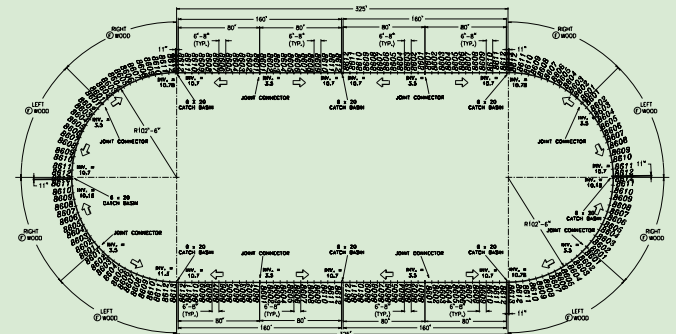

Standard Non-Sloped Slot Drain Track Layout

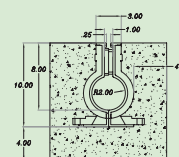
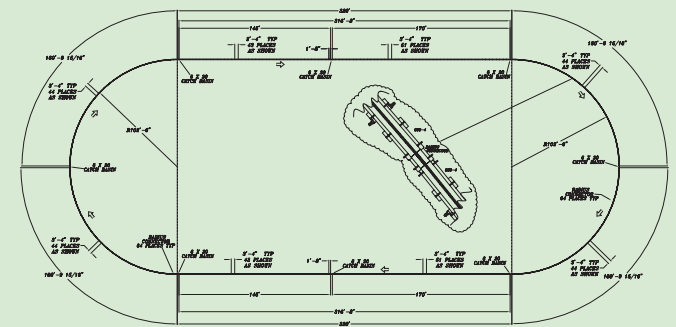

ZURN INDUSTRIES, LLC FLO-THRU OPERATION, 1801 PITTSBURGH AVENUE, ERIE, PA, U.S.A. 16502

PHONE: 716-665-1132 FAX: 716-665-1135 www.zurn.com

In Canada Call:

ZURN INDUSTRIES LIMITED 3544 NASHUA DRIVE, MISSISSAUGA, ONTARIO L4V 1L2

PHONE: 905-405-8272 FAX: 905-405-1292

