



# WASTE ARMS

## ZR2319-7-SC TO ZR7319-24-RB

### TAG \_\_\_\_\_

**Engineering Specification:** Zurn ZR2319-7-SC TO ZR7319-24-RB –  
Satin chrome and rough brass slip joint connection waste arms with die  
cast nut.

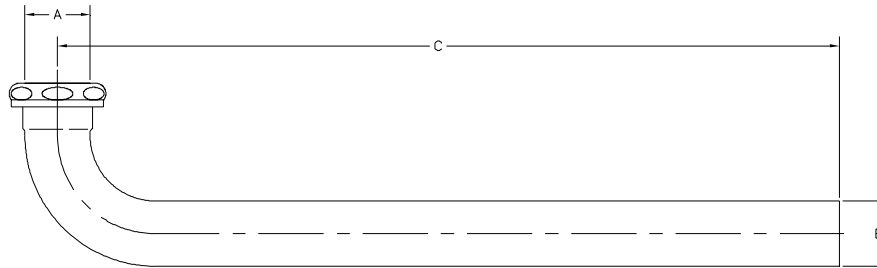

PRODUCT NUMBER	MATERIAL	DIMENSIONS			GAUGE	CARTON QTY.
		A in.[mm]	B in.[mm]	C in.[mm]		
ZR2319-7-SC	Satin Chrome	1-1/2[38]	1-1/2[38]	7[178]	20	30
ZR2319-10-SC	Satin Chrome	1-1/2[38]	1-1/2[38]	10[254]	20	30
ZR2319-12-SC	Satin Chrome	1-1/2[38]	1-1/2[38]	12[305]	20	20
ZR2319-12-RB	Rough Brass	1-1/2[38]	1-1/2[38]	12[305]	20	20
ZR2319-15-SC	Satin Chrome	1-1/2[38]	1-1/2[38]	15[381]	20	20
ZR2319-15-RB	Rough Brass	1-1/2[38]	1-1/2[38]	15[381]	20	20
ZR2319-20-SC	Satin Chrome	1-1/2[38]	1-1/2[38]	20[508]	20	20
ZR2319-24-SC	Satin Chrome	1-1/2[38]	1-1/2[38]	24[610]	20	15
ZR2319-24-RB	Rough Brass	1-1/2[38]	1-1/2[38]	24[610]	20	15
ZR7319-7-SC	Satin Chrome	1-1/2[38]	1-1/2[38]	7[178]	17	30
ZR7319-10-SC	Satin Chrome	1-1/2[38]	1-1/2[38]	10[254]	17	30
ZR7319-12-SC	Satin Chrome	1-1/2[38]	1-1/2[38]	12[305]	17	20
ZR7319-12-RB	Rough Brass	1-1/2[38]	1-1/2[38]	12[305]	17	20
ZR7319-15-SC	Satin Chrome	1-1/2[38]	1-1/2[38]	15[381]	17	20
ZR7319-15-RB	Rough Brass	1-1/2[38]	1-1/2[38]	15[381]	17	20
ZR7319-20-SC	Satin Chrome	1-1/2[38]	1-1/2[38]	20[508]	17	20
ZR7319-24-SC	Satin Chrome	1-1/2[38]	1-1/2[38]	24[610]	17	15
ZR7319-24-RB	Rough Brass	1-1/2[38]	1-1/2[38]	24[610]	17	15

#### OPTIONAL ACCESSORIES

Suffix	Description
____ -B	Brass Nut

ZURN INDUSTRIES, LLC ♦ COMMERCIAL BRASS OPERATION ♦ 2640 SOUTH WORK STREET ♦ FALCONER NY 14733

Phone: 1-716-665-1132 ♦ Fax: 1-716-665-1135 ♦ World Wide Web: [www.zurn.com](http://www.zurn.com)

In Canada: ZURN INDUSTRIES LIMITED ♦ 3544 Nashua Drive ♦ Mississauga, Ontario L4V1L2 ♦ Phone: 905/405-8272 Fax: 905/405-1292