



PEX-AI-PEX Brass Compression Coupling - QHPAP__C

Specification Sheet

Tag _____

Dimensional Data: Inches and [mm] are subject to manufacturing tolerances and change without notice.

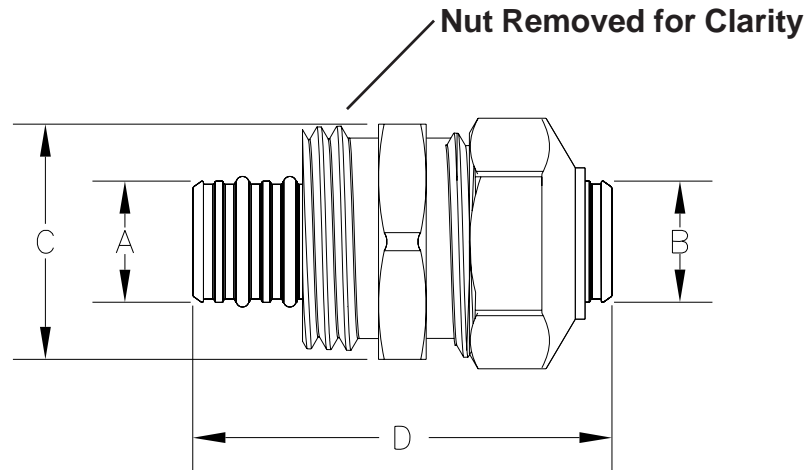

Part Number	Nominal Size	'A' in [mm]	'B' in [mm]	'C' in [mm]	'D' in [mm]
QHPAPC22C	3/8"	0.330 [8.4]	0.330 [8.4]	.765 [19.4]	1.87 [47.5]
QHPAPC33C	1/2"	0.482 [12.2]	0.482 [12.2]	0.91 [23.0]	1.87 [47.5]
QHPAPCJJC	5/8"	0.620 [15.7]	0.620 [15.7]	1.06 [27.0]	1.91 [48.5]
QHPAPC44C	3/4"	0.781 [19.8]	0.781 [19.8]	1.30 [33.0]	1.93 [49.0]
QHPAPC55C	1"	0.998 [25.3]	0.998 [25.3]	1.58 [40.0]	2.01 [51.0]

Engineering Specification: ZurnPEX® brass PEX-AI-PEX compression coupling. The QHPAPC__C coupling to connect PEX-AI-PEX tubing to PEX-AI-PEX tubing. Tubing is sealed with the use of two **buna-N** O-rings per barb. For use with PEX-AI-PEX Alumicor® tubing made to ASTM F1281. For use in radiant heating and snow melting systems.

Accessories

- ___ **Q2PAPX** 3/8" Alumicor® PEX-AI-PEX
- ___ **Q3PAPX** 1/2" Alumicor® PEX-AI-PEX
- ___ **QJPAPX** 5/8" Alumicor® PEX-AI-PEX
- ___ **Q4PAPX** 3/4" Alumicor® PEX-AI-PEX
- ___ **Q5PAPX** 1" Alumicor® PEX-AI-PEX

Rev. A	Date: 11/06/08	C.N. No. 99353
Dwg. No. 83668		Prod. No. QHPAPC__C